



भारतीय गैर न्यायिक

पचास  
रुपये

रु.50

FIFTY  
RUPEES

Rs.50



INDIA NON JUDICIAL

पश्चिमबङ्ग पश्चिम बंगाल WEST BENGAL

A 392255

Handwritten notes in Bengali script, including names and dates.

Handwritten signature or name on the right side.



অসুস্থতায়। প্র. টি. প্র. ডাক, ডাকঘর, কালী-বর্ধমান,

বিজ্ঞপ্তি-১। শ্রী অসুস্থতায়-লাশ। ২। শ্রী অসুস্থতায়-লাশ। ৩। শ্রী  
 অসুস্থতায়-লাশ। ৪। শ্রী অসুস্থতায়-লাশ। ৫। শ্রী অসুস্থতায়-লাশ। ৬। শ্রী অসুস্থতায়-লাশ। ৭। শ্রী অসুস্থতায়-লাশ।

भारतीय गैर न्यायिक

पचास  
रुपये

रु.50



FIFTY  
RUPEES

Rs.50

INDIA NON JUDICIAL

पश्चिम बंगाल WEST BENGAL

A 392956

Handwritten text in Bengali script, including names like 'Ramesh Chandra' and 'Sankar Das', and dates like '15/11/1956'.

Handwritten signature and a blue circular stamp.

Handwritten text in Bengali script, likely a list or record of names and dates, such as '1/1/1956', '2/1/1956', etc.



भारतीय गैर न्यायिक

पचास  
रुपये

रु.50



FIFTY  
RUPEES

Rs.50

INDIA NON JUDICIAL

পশ্চিমবঙ্গ পশ্চিম বঙ্গাল WEST BENGAL

A 392258

Handwritten signatures in Bengali script, including names like 'Ramu', 'Ramu', and 'Ramu'.

Handwritten signature in Bengali script.



কম্পন দ্বারা স্বাক্ষরিত সনপতি বিক্রম জ্যোতি কোবালি পত্র সিদ্ধি-  
কর্মকর্তা- নিম্নেব তদগীত কর্তি সনপতি গত্র হুঁকরি-৩০.১.৬২  
তদ্বিধে উদ্ভবকা- আর- বেঙ্গলগার- জামিগম বেঙ্গলগারকৃত-  
১৭৬৩ নং কোবালি- দলিতমুখে উদ্ভবকা- নিবাসি ছেলগাম পাও-  
১০. নিবাসি বনপাস কামগার- পাড়া- নিবাসি- গঙ্গাপ্রসাদ সিঙ্গী পাবিদ









SITE PLAN OF MOUZA - GUSKARA - P.S. AUSHGRAM.  
 DIST BURDWAN. T.L NO - 15R/110. PLOT NO ~~2782~~ <sup>3830</sup>.  
 PART AREA - 1 1/2 SATAK (MORE/LESS)  
 MARK (A). COLOUR RED BORDER



SCALE 1" = 22' 0"

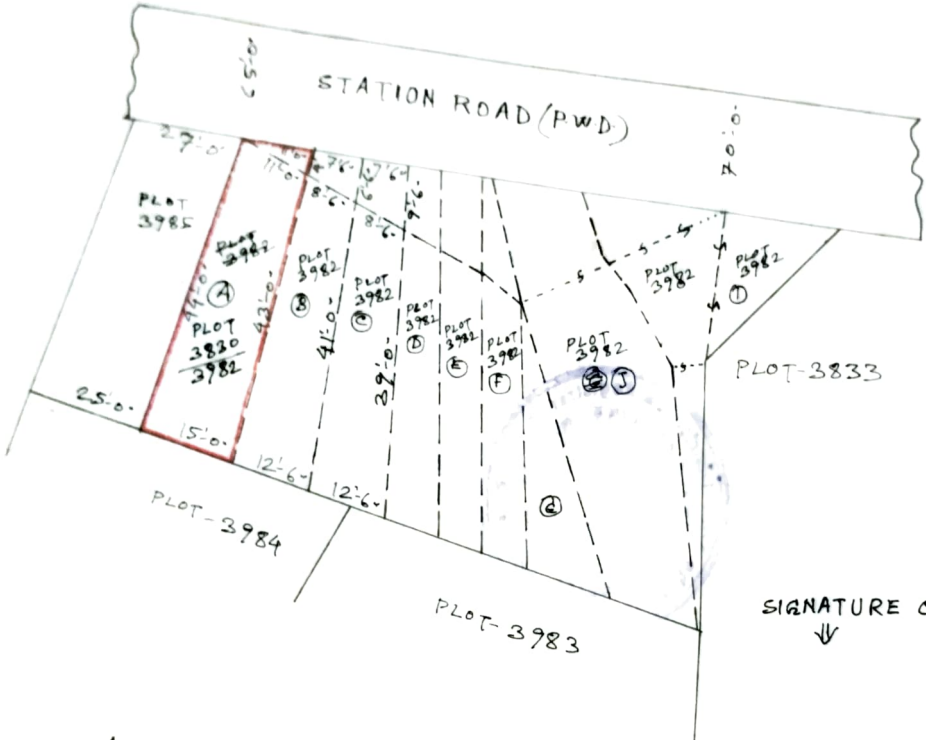

SIGNATURE OF OWNER  
 ↓

Drawn by  
 Abdul Hoque Munsifi

44th District Sub-Registrar  
 Guskara, Dist. Burdwan

44th District Sub-Registrar  
 Private Area  
 Guskara, Dist. Burdwan  
 West Bengal  
 India

*(Handwritten signature and notes in Bengali script)*

# SPECIMEN FORM FOR TEN FINGERPRINTS



	Little Finger	Ring Finger	Middle Finger	Fore Finger	Thumb
Right Hand	Thumb	Fore Finger	Middle Finger	Ring Finger	Little Finger



	Little Finger	Ring Finger	Middle Finger	Fore Finger	Thumb
Right Hand	Thumb	Fore Finger	Middle Finger	Ring Finger	Little Finger



	Little Finger	Ring Finger	Middle Finger	Fore Finger	Thumb
Left Hand	Little Finger	Ring Finger	Middle Finger	Fore Finger	Thumb

	Thumb	Fore Finger	Middle Finger	Ring Finger	Little Finger
Right Hand	Thumb	Fore Finger	Middle Finger	Ring Finger	Little Finger



	Little Finger	Ring Finger	Middle Finger	Fore Finger	Thumb
Left Hand	Little Finger	Ring Finger	Middle Finger	Fore Finger	Thumb

	Thumb	Fore Finger	Middle Finger	Ring Finger	Little Finger
Right Hand	Thumb	Fore Finger	Middle Finger	Ring Finger	Little Finger

# SPECIAL FORM FOR TEN FINGERPRINTS

Little Finger     Ring Finger     Middle Finger     Fore Finger     Thumb



	Thumb	Fore Finger	Middle Finger	Ring Finger	Little Finger
Right Hand					



	Little Finger	Ring Finger	Middle Finger	Fore Finger	Thumb
Left Hand					
Right Hand					



	Little Finger	Ring Finger	Middle Finger	Fore Finger	Thumb
Left Hand					
Right Hand					



	Little Finger	Ring Finger	Middle Finger	Fore Finger	Thumb
Left Hand					
Right Hand					

# SPECIMEN FORM FOR TEN FINGERPRINTS



	Little Finger	Ring Finger	Middle Finger	Fore Finger	Thumb
Right Hand					



	Little Finger	Ring Finger	Middle Finger	Fore Finger	Thumb
Right Hand					



	Little Finger	Ring Finger	Middle Finger	Fore Finger	Thumb
Right Hand					



	Little Finger	Ring Finger	Middle Finger	Fore Finger	Thumb
Right Hand					

# SPECIFIC FORM FOR TEN FINGERPRINTS



	Little Finger	Ring Finger	Middle Finger	Fore Finger	Thumb
Right Hand					



	Little Finger	Ring Finger	Middle Finger	Fore Finger	Thumb
Right Hand					



	Little Finger	Ring Finger	Middle Finger	Fore Finger	Thumb
Right Hand					



	Little Finger	Ring Finger	Middle Finger	Fore Finger	Thumb
Left Hand					

	Thumb	Fore Finger	Middle Finger	Ring Finger	Little Finger
Right Hand					

# SPECIMEN FORM FOR TEN FINGERPRINTS

	Little Finger	Ring Finger	Middle Finger	Fore Finger	Thumb
<b>PHOTO</b>	Thumb	Fore Finger	Middle Finger	Ring Finger	Little Finger
	Right Hand				
<b>PHOTO</b>	Little Finger	Ring Finger	Middle Finger	Fore Finger	Thumb
	Right Hand	Thumb	Fore Finger	Middle Finger	Ring Finger
<b>PHOTO</b>	Little Finger	Ring Finger	Middle Finger	Fore Finger	Thumb
	Right Hand	Thumb	Fore Finger	Middle Finger	Ring Finger
<b>PHOTO</b>	Little Finger	Ring Finger	Middle Finger	Fore Finger	Thumb
	Right Hand	Thumb	Fore Finger	Middle Finger	Ring Finger



**Government Of West Bengal**  
**Office Of the A. D. S. R. GUSKARA**  
**District:-Burdwan**

**Endorsement For Deed Number : I - 02680 of 2010**  
**(Serial No. 00106 of 2007)**

**On 18/01/2007**

**Payment of Fees:**

Fee Paid in rupees under article : A(1) = 44/- on 18/01/2007

**Certificate of Market Value(WB PUVI rules of 2001)**

Certified that the market value of this property which is the subject matter of the deed has been assessed at Rs.-67000/-

Certified that the required stamp duty of this document is Rs.- 4020 /- and the Stamp duty paid as: Impresive Rs.- 300/-

**Presentation(Under Section 52 & Rule 22A(3) 46(1),W.B. Registration Rules,1962)**

Presented for registration at 13.48 hrs on :18/01/2007, at the Office of the A. D. S. R. GUSKARA by Shri Amreshmani Laha , one of the Executants.

**Admission of Execution(Under Section 58,W.B.Registration Rules,1962)**

Execution is admitted on 18/01/2007 by

1. Shri Amreshmani Laha, son of Late Amulyacharan Laha , GUSHKARA, Thana:-Ausgram, District:-Burdwan, WEST BENGAL, India, P.O. :- , By Caste Hindu, By Profession : Cultivation
2. Shri Pareshmani Laha, son of Late Amulyacharan Laha , GUSHKARA, Thana:-Ausgram, District:-Burdwan, WEST BENGAL, India, P.O. :- , By Caste Hindu, By Profession : Cultivation
3. Shri Nareshmani Laha, son of Late Amulyacharan Laha , GUSHKARA, Thana:-Ausgram, District:-Burdwan, WEST BENGAL, India, P.O. :- , By Caste Hindu, By Profession : Cultivation
4. Shri Nihar Ranjan Laha, son of Late Narayanmani Laha , GUSHKARA, Thana:-Ausgram, District:-Burdwan, WEST BENGAL, India, P.O. :- , By Caste Hindu, By Profession : Cultivation
5. Shri Manoranjan Laha, son of Late Narayanmani Laha , GUSHKARA, Thana:-Ausgram, District:-Burdwan, WEST BENGAL, India, P.O. :- , By Caste Hindu, By Profession : Cultivation
6. Shri Suvash Ranjan Laha, son of Late Narayanmani Laha , GUSHKARA, Thana:-Ausgram, District:-Burdwan, WEST BENGAL, India, P.O. :- , By Caste Hindu, By Profession : Cultivation
7. Shri Chittaranjan Laha, son of Late Narayanmani Laha , GUSHKARA, Thana:-Ausgram, District:-Burdwan, WEST BENGAL, India, P.O. :- , By Caste Hindu, By Profession : Cultivation
8. Shri Kesab Ranjan Laha, son of Late Narayanmani Laha , GUSHKARA, Thana:-Ausgram, District:-Burdwan, WEST BENGAL, India, P.O. :- , By Caste Hindu, By Profession : Cultivation
9. Shri Tapan Laha, son of Late Balaimani Laha , GUSHKARA, Thana:-Ausgram, District:-Burdwan, WEST BENGAL, India, P.O. :- , By Caste Hindu, By Profession : Cultivation
10. Shri Swapan Laha, son of Late Subalmani Laha , GUSHKARA, Thana:-Ausgram, District:-Burdwan, WEST BENGAL, India, P.O. :- , By Caste Hindu, By Profession : Cultivation

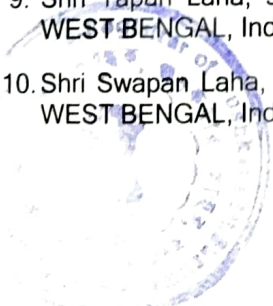

**( Kashikanta Sarkar )**  
**ADDITIONAL DISTRICT SUB-REGISTRAR**



**Government Of West Bengal**  
**Office Of the A. D. S. R. GUSKARA**  
**District:-Burdwan**

**Endorsement For Deed Number : I - 02680 of 2010**  
**(Serial No. 00106 of 2007)**

11. Shri Sunil Laha, son of Late Subalmani Laha , GUSHKARA, Thana:-Ausgram, District:-Burdwan, WEST BENGAL, India, P.O. :- , By Caste Hindu, By Profession : Cultivation
12. Shri Sudhir Laha, son of Late Subalmani Laha , GUSHKARA, Thana:-Ausgram, District:-Burdwan, WEST BENGAL, India, P.O. :- , By Caste Hindu, By Profession : Cultivation
13. Shri Shyamal Laha, son of Late Subalmani Laha , GUSHKARA, Thana:-Ausgram, District:-Burdwan, WEST BENGAL, India, P.O. :- , By Caste Hindu, By Profession : Cultivation
14. Tulsi Mukhopadhyay, wife of Late Kamakshya Charan Mukhopadhyay , GUSHKARA, Thana:-Ausgram, District:-Burdwan, WEST BENGAL, India, P.O. :- , By Caste Hindu, By Profession : House wife  
Identified By Sunil Barui, son of Late Sanand Barui, GUSHKARA, Thana:-Ausgram, District:-Burdwan, WEST BENGAL, India, P.O. :- , By Caste: Hindu, By Profession: Others.
15. Shri Sukumar Laha, son of Late Subalmani Laha , GUSHKARA, Thana:-Ausgram, District:-Burdwan, WEST BENGAL, India, P.O. :- , By Caste Hindu, By Profession : Cultivation  
Identified By Kishor Samanta, son of Sri Sisir Samanta, Village:Telota, District:-Burdwan, WEST BENGAL, India, P.O. :-Hatkirtinagar , By Caste: Hindu, By Profession: Others.

( Kashikanta Sarkar )  
ADDITIONAL DISTRICT SUB-REGISTRAR

**On 19/07/2010**

**Certificate of Admissibility(Rule 43,W.B. Registration Rules 1962)**

Admissible under rule 21 of West Bengal Registration Rule, 1962 duly stamped under schedule 1A. Article number : 23 of Indian Stamp Act 1899. also under section 5 of West Bengal Land Reforms Act, 1955; Court fee stamp paid Rs.10/-

**Deficit stamp duty**

Deficit stamp duty Rs. 3720/- is paid, by the draft number 050759, Draft Date 15/07/2010, Bank Name State Bank of India, ITACHANDA ADB, received on 19/07/2010

**Deficit Fees paid**

Deficit amount of Registration fees is realized under Article in rupees :

A(1) = 682/- on 19/07/2010.

( Kashikanta Sarkar )  
ADDITIONAL DISTRICT SUB-REGISTRAR



( Kashikanta Sarkar )  
ADDITIONAL DISTRICT SUB-REGISTRAR